

### Standard Coupling Type EE with Finished Straight Bores

Standard Couplings Type EE are generally used on close-connected equipment and may be mounted for either wide or close shaft separations, at the user's option. This permits ready installation on existing shaft separations and eliminates moving the connected equipment to suit the coupling.

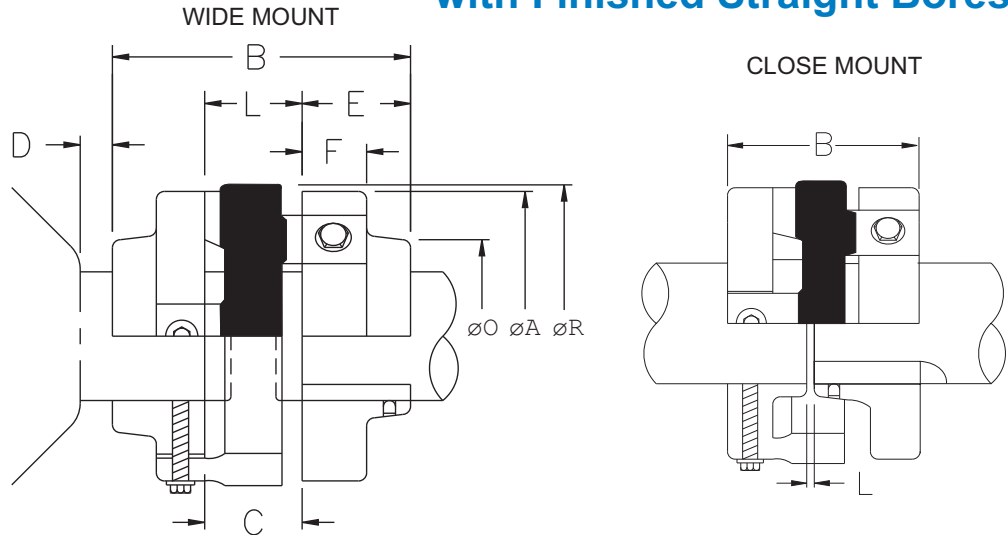

TABLE 1

Coupling Size	WIDE MOUNT												CLOSE MOUNT			
	Bore with Standard Keyway		Stock Rough Bore	Hub Sep. L	Shaft Separation C		ø A	B	D	E	F	ø O	ø R	Coupling Size	Hub & Shaft Separation L	B
	Max.	Min.			Min.	Max.										
20	1 1/8	1/2	3/8	1	1/8	1	3 11/16	3 1/8	1/8	1 1/16	5/8	1 7/8	4	20	1/8	2 1/4
30	1 1/2	1/2	3/8	1 1/2	1/8	1 1/2	4 3/8	4 1/8	1/8	1 5/16	5/8	2 7/16	4 5/8	30	1/8	2 3/4
40	1 7/8	1/2	3/8	1 5/8	1/8	1 5/8	5 3/8	5 1/8	1/8	1 3/4	1	2 3/4	5 11/16	40	1/8	3 5/8
*50	2 1/8	3/4	5/8	2 1/8	1/8	2 1/8	6 1/16	6 1/8	1/8	2	1	3 1/8	6 3/4	50	1/8	4 1/8
*60	2 7/8	1 1/8	15/16	2 1/8	1/8	2 1/8	7	6 1/8	1/8	2	1	4 7/32	7 5/8	60	1/8	4 1/8
70	3	1 1/4	1 1/16	2 3/8	1/8	2 3/8	8	6 5/8	1/8	2 1/8	1	4 7/16	8 11/16	70	1/8	4 3/8
*80	3 3/4	1 1/2	1 1/4	3	1/8	3	9 7/16	8 3/8	1/8	2 11/16	1 1/4	5 5/16	10 1/2	80	1/8	5 1/2
90	4 3/4	1 3/4	1 1/2	4 1/8	1/8	4 1/8	12 1/8	11 1/8	1/8	3 1/2	1 1/2	6 5/8	13 1/16	90	1/8	7 1/8
100	5 3/8	2 1/4	2	4 1/8	1/8	4 1/8	13 7/8	12 1/8	1/8	4	2	7 3/8	15 1/8	100	1/8	8 1/8

NOTES: Finished Bored E Hubs can be ordered by specific Bore size.  
 Complete coupling consists of 2 E Hubs and 1 Replaceable Element.  
 \* 50, 60 and 80 EE hubs are also stocked in steel. Consult KOP-FLEX.

Coupling Size	Complete Coupling No Bore		E Hub No Bore		Element W/ Fastener	
	Part No.	Wt.	Part No.	Wt.	Part No.	Wt.
20	20 EE	2	20 EHUB	1	20 ELEMENT	1
30	30 EE	3	30 EHUB	1	30 ELEMENT	1
40	40 EE	6	40 EHUB	2	40 ELEMENT	1
50	50 EE	9	50 EHUB	3	50 ELEMENT	2
60	60 EE	12	60 EHUB	3	60 ELEMENT	3
70	70 EE	17	70 EHUB	4	70 ELEMENT	5
80	80 EE	31	80 EHUB	8	80 ELEMENT	9
90	90 EE	59	90 EHUB	15	90 ELEMENT	16
100	100 EE	96	100 EHUB	29	100 ELEMENT	18

**Standard Hubs are Available From Stock, in Aluminum, Steel and Stainless Steel.**

## Long Hub Type L

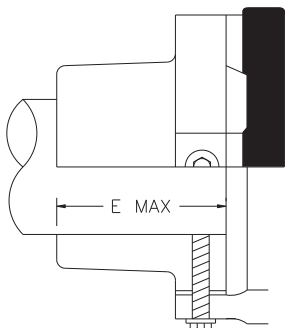

**LONG HUB—TYPE L**  
 Available for Wide Mount only

### ELASTOMERIC L Hub Rough Bored

Coupling Size	Part No.	EMAX	Bore with Standard Keyway (in.)		Stock Rough Bore
			Min.	Max.	
60	60 LHUB	3 9/16	1 3/8	3	1 1/4
70	70 LHUB	4	1 3/8	3 1/8	1 1/4
80	80 LHUB	4 11/16	1 3/8	4 1/8	1 1/4
90	90 LHUB	4 15/16	1 9/16	4 3/4	1 7/16
100	100 LHUB	5 7/16	2	5 3/8	1 7/8